

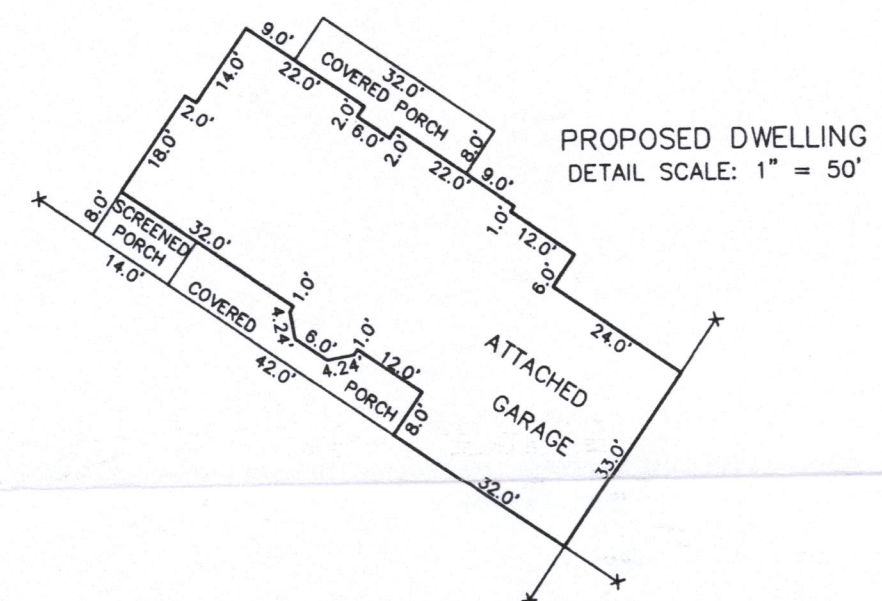

LOT 1 OF CERTIFIED SURVEY MAP NO 4971, RECORDED IN THE OFFICE OF THE REGISTER OF DEEDS IN AND FOR WORTH COUNTY AS DOCUMENT NO. 1040070, BEING PART OF THE NORTHWEST 1/4 AND THE SOUTHWEST 1/4 OF THE NORTHEAST 1/4 OF SECTION 26, TOWNSHIP 3 NORTH, RANGE 16 EAST OF THE FOURTH PRINCIPAL MERIDIAN IN THE TOWNSHIP OF SUGAR CREEK, COUNTY OF WORTH, AND STATE OF WISCONSIN.

[illegible]

SCALE:  1" = 100'

PROPERTY CORNERS WERE NOT RELOCATED AS PART OF THIS SURVEY.

BEARINGS HEREON RELATE TO THE WEST LINE OF THE NORTHEAST 1/4
OF SECTION 26-3-16, ASSUMED BEARING NORTH 02°11'54" WEST.

PROPOSED DWELLING STAKED AS SHOWN WITH 10 FOOT CONTROL ON THE TWO LINES AS SHOWN. IT IS THE CONTRACTOR'S RESPONSIBILITY TO VERIFY ALL STAKES FOR LOCATION AND DIMENSION PRIOR TO CONSTRUCTION. IF THERE ARE ANY DISCREPANCIES, PLEASE CONTACT THIS OFFICE AT ONCE.

WETLANDS AS SHOWN WERE PLOTTED PER DIGITAL INFORMATION
RECEIVED FROM AMBIT LAND SURVEYING ON FEBRUARY 9, 2021 PER
FIELD STAKING BY S.E.W.R.P.C. ON JULY 20 AND 22, 2020.

"I hereby certify that I have surveyed the above described property and that the above map is a correct representation thereof and shows the size and location of the property, its exterior boundaries, the location of all visible structures and dimensions of all principal buildings thereon, boundary fences, apparent easements, roadways and encroachments, if any."

"This survey is made for the use of the present owners of the property, and those who purchase, mortgage, or guarantee the title thereto within one year from date hereof."

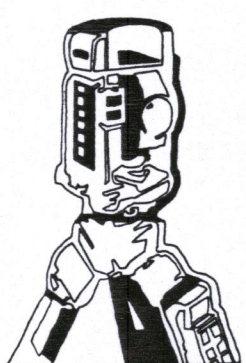

B.W. SURVEYING, INC.

412 N. PINE STREET
BURLINGTON, WI 53105
(262)-767-0225

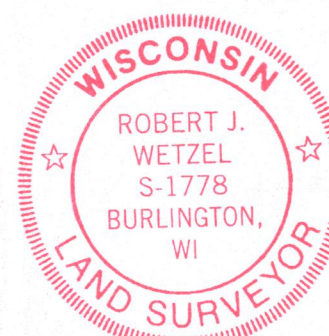

THIS IS NOT AN ORIGINAL PRINT
UNLESS THIS SEAL IS RED.

Robert J. Wetzel
ROBERT J. WETZEL S-1778

| | |
|--------------------|-------------------------|
| DRAWN BY: BW/ MT | DATE: JULY 14, 2021 |
| CHECKED BY: BW/ DW | DRAWING NO.: 10445 PROP |
| JOB NO.: 10455 | SHEET 1 OF 1 |

316-2500

GA4971-1